

Śruby pasowane

Stal/stal nierdzewna, z kołnierzem

SPECYFIKACJA

Wersja ze stali

- Wytrzymałość na rozciąganie klasa 12.9
- Powierzchnia oksydowana na czarno
- Część walcowa o średnicy d_1 szlifowana

Wersja ze stali nierdzewnej NI

- AISI 304 (A2)
- Część walcowa o średnicy d_1 szlifowana

INFORMACJE

Śruby pasowane ISO 7379 to ekonomiczne elementy konstrukcyjne do szerokiego zastosowania.

Maksymalny moment dokręcania nie jest definiowany klasą wytrzymałości materiału (12.9), lecz jest ograniczony małą powierzchnią oporową tba śruby oraz podtoczeniami pomiędzy średnicami d_1 , d_2 i d_3 .

Odchyłki od standardu ISO:

- Brak informacji odnośnie koncentryczności elementów opisanych w normie tolerancjami 2 IT 13 oraz 2 IT 10
- Oficjalna norma ISO zawiera następujące wymiary dla d_1 - d_2 : 6.5-M5 / 13-M10 / 25-M20
- Rozmiary 4-M3 oraz M4-M5 nie są ujęte w oficjalnej normie ISO

DANE TECHNICZNE

- Właściwości stali nierdzewnej (patrz strona A26)
- ISO-Podstawowe tolerancje (patrz strona A21)
- Dane dotyczące wytrzymałości śrub (patrz strona A20)

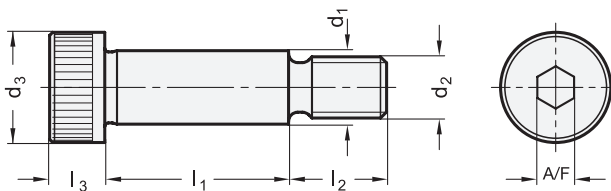

Przykład montażu

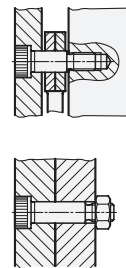

ISO 7379

Oznaczenie	d1 f9	d2	l1 +0.25	d3	l2	l3	A/F	⚖
ISO 7379-4-M3-4	4	M3	4	7	7	3	2	1
ISO 7379-4-M3-5	4	M3	5	7	7	3	2	2
ISO 7379-4-M3-6	4	M3	6	7	7	3	2	2
ISO 7379-4-M3-8	4	M3	8	7	7	3	2	2
ISO 7379-4-M3-10	4	M3	10	7	7	3	2	2
ISO 7379-4-M3-12	4	M3	12	7	7	3	2	3
ISO 7379-4-M3-16	4	M3	16	7	7	3	2	3
ISO 7379-4-M3-20	4	M3	20	7	7	3	2	3
ISO 7379-4-M3-25	4	M3	25	7	7	3	2	4
ISO 7379-4-M3-30	4	M3	30	7	7	3	2	4
ISO 7379-5-M4-5	5	M4	5	9	8	4	2.5	3
ISO 7379-5-M4-6	5	M4	6	9	8	4	2.5	3
ISO 7379-5-M4-8	5	M4	8	9	8	4	2.5	4
ISO 7379-5-M4-10	5	M4	10	9	8	4	2.5	4
ISO 7379-5-M4-12	5	M4	12	9	8	4	2.5	4
ISO 7379-5-M4-16	5	M4	16	9	8	4	2.5	5
ISO 7379-5-M4-20	5	M4	20	9	8	4	2.5	5
ISO 7379-5-M4-25	5	M4	25	9	8	4	2.5	7
ISO 7379-5-M4-30	5	M4	30	9	8	4	2.5	7
ISO 7379-5-M4-40	5	M4	40	9	8	4	2.5	10
ISO 7379-6-M5-10	6	M5	10	10	9.5	4.5	3	8
ISO 7379-6-M5-12	6	M5	12	10	9.5	4.5	3	8
ISO 7379-6-M5-16	6	M5	16	10	9.5	4.5	3	10
ISO 7379-6-M5-20	6	M5	20	10	9.5	4.5	3	10
ISO 7379-6-M5-25	6	M5	25	10	9.5	4.5	3	11
ISO 7379-6-M5-30	6	M5	30	10	9.5	4.5	3	11
ISO 7379-6-M5-35	6	M5	35	10	9.5	4.5	3	12
ISO 7379-6-M5-40	6	M5	40	10	9.5	4.5	3	15
ISO 7379-6-M5-45	6	M5	45	10	9.5	4.5	3	16
ISO 7379-6-M5-50	6	M5	50	10	9.5	4.5	3	17
ISO 7379-6-M5-55	6	M5	55	10	9.5	4.5	3	18
ISO 7379-6-M5-60	6	M5	60	10	9.5	4.5	3	18
ISO 7379-6-M5-65	6	M5	65	10	9.5	4.5	3	18
ISO 7379-6-M5-70	6	M5	70	10	9.5	4.5	3	19
ISO 7379-6-M5-80	6	M5	80	10	9.5	4.5	3	21
ISO 7379-8-M6-16	8	M6	16	13	10	5.5	4	14
ISO 7379-8-M6-20	8	M6	20	13	10	5.5	4	15
ISO 7379-8-M6-25	8	M6	25	13	10	5.5	4	16
ISO 7379-8-M6-30	8	M6	30	13	10	5.5	4	18
ISO 7379-8-M6-35	8	M6	35	13	10	5.5	4	19
ISO 7379-8-M6-40	8	M6	40	13	10	5.5	4	21
ISO 7379-8-M6-45	8	M6	45	13	10	5.5	4	25
ISO 7379-8-M6-50	8	M6	50	13	10	5.5	4	26
ISO 7379-8-M6-55	8	M6	55	13	10	5.5	4	28
ISO 7379-8-M6-60	8	M6	60	13	10	5.5	4	30
ISO 7379-8-M6-65	8	M6	65	13	10	5.5	4	32
ISO 7379-8-M6-70	8	M6	70	13	10	5.5	4	34
ISO 7379-8-M6-80	8	M6	80	13	10	5.5	4	38
ISO 7379-8-M6-90	8	M6	90	13	10	5.5	4	42
ISO 7379-8-M6-100	8	M6	100	13	10	5.5	4	47
ISO 7379-10-M8-16	10	M8	16	16	13	7	5	23
ISO 7379-10-M8-20	10	M8	20	16	13	7	5	25
ISO 7379-10-M8-25	10	M8	25	16	13	7	5	29
ISO 7379-10-M8-30	10	M8	30	16	13	7	5	31
ISO 7379-10-M8-35	10	M8	35	16	13	7	5	33
ISO 7379-10-M8-40	10	M8	40	16	13	7	5	41
ISO 7379-10-M8-45	10	M8	45	16	13	7	5	43

ISO 7379

Oznaczenie	d1 f9	d2	l1 +0.25	d3	l2	l3	A/F	⚖
ISO 7379-10-M8-50	10	M8	50	16	13	7	5	45
ISO 7379-10-M8-55	10	M8	55	16	13	7	5	47
ISO 7379-10-M8-60	10	M8	60	16	13	7	5	50
ISO 7379-10-M8-65	10	M8	65	16	13	7	5	53
ISO 7379-10-M8-70	10	M8	70	16	13	7	5	56
ISO 7379-10-M8-80	10	M8	80	16	13	7	5	62
ISO 7379-10-M8-90	10	M8	90	16	13	7	5	68
ISO 7379-10-M8-100	10	M8	100	16	13	7	5	75
ISO 7379-12-M10-16	12	M10	16	18	16	9	6	35
ISO 7379-12-M10-20	12	M10	20	18	16	9	6	39
ISO 7379-12-M10-25	12	M10	25	18	16	9	6	43
ISO 7379-12-M10-30	12	M10	30	18	16	9	6	47
ISO 7379-12-M10-35	12	M10	35	18	16	9	6	51
ISO 7379-12-M10-40	12	M10	40	18	16	9	6	56
ISO 7379-12-M10-45	12	M10	45	18	16	9	6	60
ISO 7379-12-M10-50	12	M10	50	18	16	9	6	65
ISO 7379-12-M10-55	12	M10	55	18	16	9	6	71
ISO 7379-12-M10-60	12	M10	60	18	16	9	6	75
ISO 7379-12-M10-65	12	M10	65	18	16	9	6	76
ISO 7379-12-M10-70	12	M10	70	18	16	9	6	83
ISO 7379-12-M10-80	12	M10	80	18	16	9	6	91
ISO 7379-12-M10-90	12	M10	90	18	16	9	6	96
ISO 7379-12-M10-100	12	M10	100	18	16	9	6	100
ISO 7379-16-M12-25	16	M12	25	24	18	11	8	85
ISO 7379-16-M12-30	16	M12	30	24	18	11	8	93
ISO 7379-16-M12-35	16	M12	35	24	18	11	8	100
ISO 7379-16-M12-40	16	M12	40	24	18	11	8	108
ISO 7379-16-M12-45	16	M12	45	24	18	11	8	116
ISO 7379-16-M12-50	16	M12	50	24	18	11	8	123
ISO 7379-16-M12-55	16	M12	55	24	18	11	8	131
ISO 7379-16-M12-60	16	M12	60	24	18	11	8	140
ISO 7379-16-M12-65	16	M12	65	24	18	11	8	148
ISO 7379-16-M12-70	16	M12	70	24	18	11	8	155
ISO 7379-16-M12-80	16	M12	80	24	18	11	8	170
ISO 7379-16-M12-90	16	M12	90	24	18	11	8	186
ISO 7379-16-M12-100	16	M12	100	24	18	11	8	200
ISO 7379-20-M16-30	20	M16	30	30	22	14	10	169
ISO 7379-20-M16-35	20	M16	35	30	22	14	10	180
ISO 7379-20-M16-40	20	M16	40	30	22	14	10	190
ISO 7379-20-M16-45	20	M16	45	30	22	14	10	208
ISO 7379-20-M16-50	20	M16	50	30	22	14	10	220
ISO 7379-20-M16-55	20	M16	55	30	22	14	10	230
ISO 7379-20-M16-60	20	M16	60	30	22	14	10	234
ISO 7379-20-M16-65	20	M16	65	30	22	14	10	260
ISO 7379-20-M16-70	20	M16	70	30	22	14	10	266
ISO 7379-20-M16-80	20	M16	80	30	22	14	10	293
ISO 7379-20-M16-90	20	M16	90	30	22	14	10	315
ISO 7379-20-M16-100	20	M16	100	30	22	14	10	340
ISO 7379-24-M20-50	24	M20	50	36	27	16	12	340
ISO 7379-24-M20-55	24	M20	55	36	27	16	12	360
ISO 7379-24-M20-60	24	M20	60	36	27	16	12	370
ISO 7379-24-M20-65	24	M20	65	36	27	16	12	400
ISO 7379-24-M20-70	24	M20	70	36	27	16	12	410
ISO 7379-24-M20-80	24	M20	80	36	27	16	12	450
ISO 7379-24-M20-90	24	M20	90	36	27	16	12	480
ISO 7379-24-M20-100	24	M20	100	36	27	16	12	520



Elementy maszyn 9



Elementy maszyn

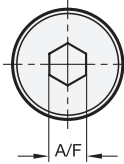
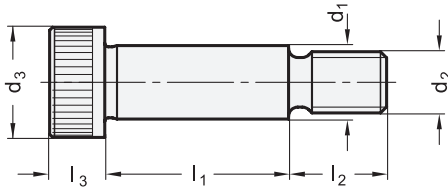

Przykład montażu

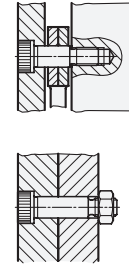

ISO 7379-NI

STAINLESS STEEL

Oznaczenie	d1 f9	d2	l1 +0.25	d3	l2	l3	A/F	Δ
ISO 7379-4-M3-4-NI	4	M3	4	7	7	3	2	1
ISO 7379-4-M3-5-NI	4	M3	5	7	7	3	2	2
ISO 7379-4-M3-6-NI	4	M3	6	7	7	3	2	2
ISO 7379-4-M3-8-NI	4	M3	8	7	7	3	2	2
ISO 7379-4-M3-10-NI	4	M3	10	7	7	3	2	2
ISO 7379-4-M3-12-NI	4	M3	12	7	7	3	2	2
ISO 7379-4-M3-16-NI	4	M3	16	7	7	3	2	3
ISO 7379-5-M4-5-NI	5	M4	5	9	8	4	2.5	3
ISO 7379-5-M4-6-NI	5	M4	6	9	8	4	2.5	3
ISO 7379-5-M4-8-NI	5	M4	8	9	8	4	2.5	4
ISO 7379-5-M4-10-NI	5	M4	10	9	8	4	2.5	4
ISO 7379-5-M4-12-NI	5	M4	12	9	8	4	2.5	4
ISO 7379-5-M4-16-NI	5	M4	16	9	8	4	2.5	5
ISO 7379-5-M4-20-NI	5	M4	20	9	8	4	2.5	5
ISO 7379-5-M4-25-NI	5	M4	25	9	8	4	2.5	6
ISO 7379-5-M4-30-NI	5	M4	30	9	8	4	2.5	7
ISO 7379-6-M5-10-NI	6	M5	10	10	9.5	4.5	3	6
ISO 7379-6-M5-12-NI	6	M5	12	10	9.5	4.5	3	6
ISO 7379-6-M5-16-NI	6	M5	16	10	9.5	4.5	3	7
ISO 7379-6-M5-20-NI	6	M5	20	10	9.5	4.5	3	8
ISO 7379-6-M5-25-NI	6	M5	25	10	9.5	4.5	3	10
ISO 7379-6-M5-30-NI	6	M5	30	10	9.5	4.5	3	10
ISO 7379-6-M5-40-NI	6	M5	40	10	9.5	4.5	3	20
ISO 7379-6-M5-50-NI	6	M5	50	10	9.5	4.5	3	14
ISO 7379-6-M5-60-NI	6	M5	60	10	9.5	4.5	3	14
ISO 7379-8-M6-16-NI	8	M6	16	13	11	5.5	4	8
ISO 7379-8-M6-20-NI	8	M6	20	13	11	5.5	4	12
ISO 7379-8-M6-25-NI	8	M6	25	13	11	5.5	4	16
ISO 7379-8-M6-30-NI	8	M6	30	13	11	5.5	4	18
ISO 7379-8-M6-40-NI	8	M6	40	13	11	5.5	4	21
ISO 7379-8-M6-50-NI	8	M6	50	13	11	5.5	4	26
ISO 7379-8-M6-60-NI	8	M6	60	13	11	5.5	4	27

ISO 7379-NI

STAINLESS STEEL

Oznaczenie	d1 f9	d2	l1 +0.25	d3	l2	l3	A/F	Δ
ISO 7379-10-M8-16-NI	10	M8	16	16	13	7	5	23
ISO 7379-10-M8-20-NI	10	M8	20	16	13	7	5	25
ISO 7379-10-M8-25-NI	10	M8	25	16	13	7	5	29
ISO 7379-10-M8-30-NI	10	M8	30	16	13	7	5	32
ISO 7379-10-M8-40-NI	10	M8	40	16	13	7	5	41
ISO 7379-10-M8-50-NI	10	M8	50	16	13	7	5	45
ISO 7379-10-M8-60-NI	10	M8	60	16	13	7	5	50
ISO 7379-10-M8-70-NI	10	M8	70	16	13	7	5	56
ISO 7379-10-M8-80-NI	10	M8	80	16	13	7	5	62
ISO 7379-10-M8-90-NI	10	M8	90	16	13	7	5	68
ISO 7379-10-M8-100-NI	10	M8	100	16	13	7	5	75
ISO 7379-12-M10-16-NI	12	M10	16	18	16	9	6	35
ISO 7379-12-M10-20-NI	12	M10	20	18	16	9	6	39
ISO 7379-12-M10-25-NI	12	M10	25	18	16	9	6	43
ISO 7379-12-M10-30-NI	12	M10	30	18	16	9	6	47
ISO 7379-12-M10-40-NI	12	M10	40	18	16	9	6	56
ISO 7379-12-M10-50-NI	12	M10	50	18	16	9	6	65
ISO 7379-12-M10-60-NI	12	M10	60	18	16	9	6	76
ISO 7379-12-M10-70-NI	12	M10	70	18	16	9	6	86
ISO 7379-12-M10-80-NI	12	M10	80	18	16	9	6	91
ISO 7379-12-M10-90-NI	12	M10	90	18	16	9	6	96
ISO 7379-12-M10-100-NI	12	M10	100	18	16	9	6	100
ISO 7379-16-M12-30-NI	16	M12	30	24	18	11	8	93
ISO 7379-16-M12-40-NI	16	M12	40	24	18	11	8	110
ISO 7379-16-M12-50-NI	16	M12	50	24	18	11	8	123
ISO 7379-16-M12-60-NI	16	M12	60	24	18	11	8	136
ISO 7379-16-M12-70-NI	16	M12	70	24	18	11	8	155
ISO 7379-16-M12-80-NI	16	M12	80	24	18	11	8	170
ISO 7379-16-M12-90-NI	16	M12	90	24	18	11	8	186
ISO 7379-16-M12-100-NI	16	M12	100	24	18	11	8	200